

5. Volume control

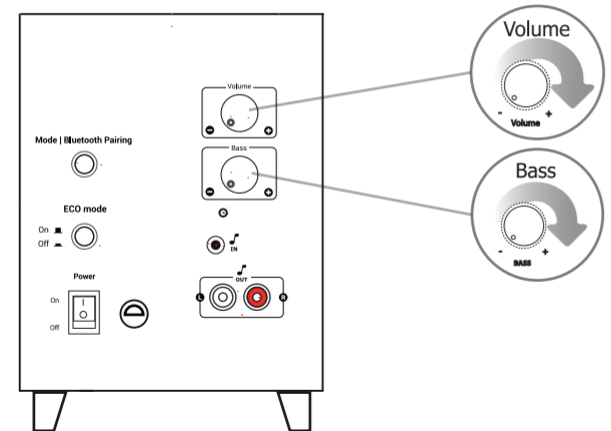

6. Installation - Windows 10/8/7

Windows 8

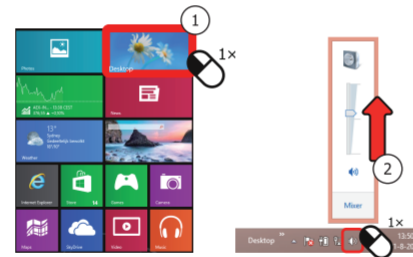

Windows 10/7

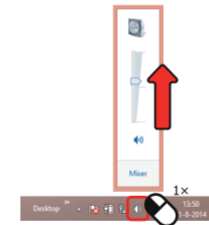

7. ECO Mode

ECO mode



on



1 hours



off



FAQ

<http://www.trust.com/21184/faq>

Trust

2.1 speaker set



Quick Installation Guide

1. Setup

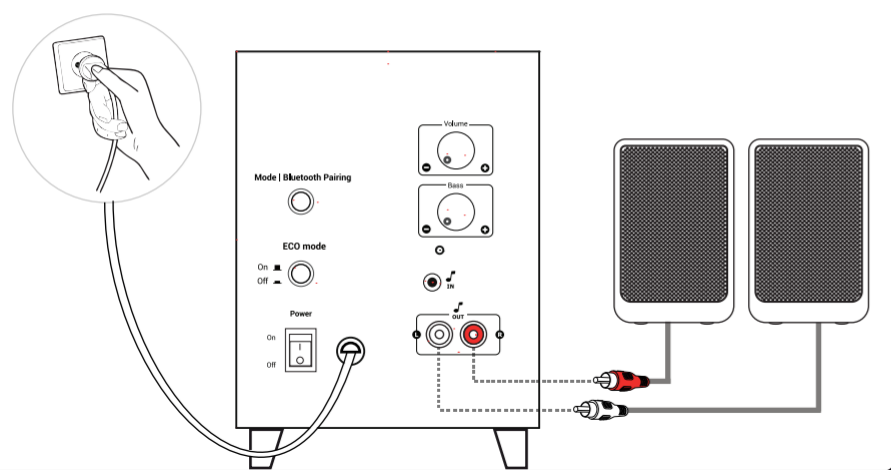

2. Wired Setup

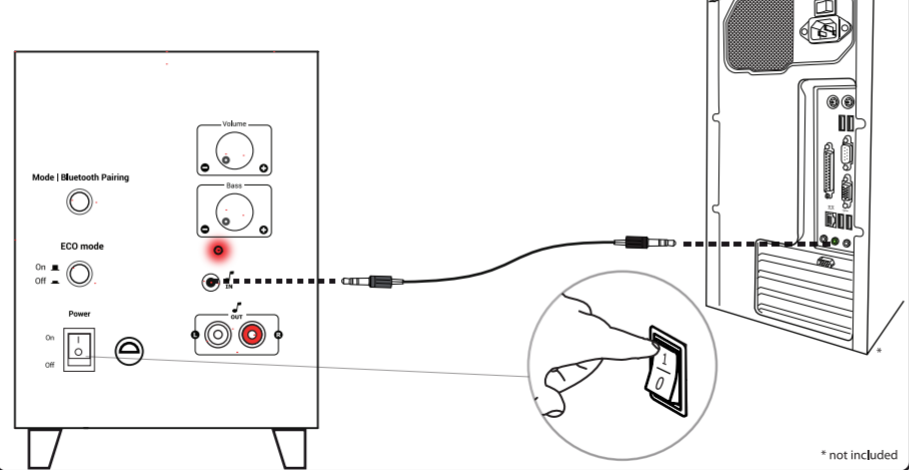

3. Wireless Setup 1/2

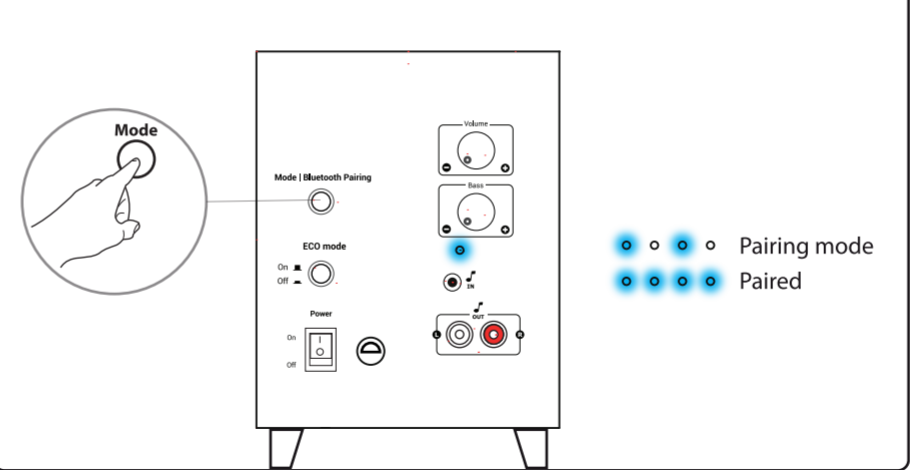

4. Wireless Setup 2/2

