

S482YHY		S482YHY		宁波市德隆机械有限公司	
设计	校对	审核	工艺	设计	校对
标准文件号	更改文件号	签名	年月日	设计标准	数量
1				1	
共 1 页		第 1 页		S482YHY-(铝合金支架)	

S482VHY-T Li-Estar

No.	Material No.	Description in English	Qty	Unit Price
1	70500620130	upper handrail	1	5,3
2	70520390130	lower handrail	1	5
3	70540084830	stop lever	1	1,9
4	70550074130	Self-propelled Lever	1	1,9
5	20340060000	foam pipe	1	0,55
6	20030030000	lever guard	1	1,1
7	60090250000	Hexagon head bolts	2	0,06
8	60150080000	Self-locking nut	2	0,05
9	70230090000	Rope Guide	1	0,7
10	60130020000	cap nut	4	0,05
11	20650170000	Brake Cable Assy plate	1	0,6
12	70780220000	selfpropelled cable	1	1,09
13	70810040000	brake cable	1	1,09
14	20580040830	quick fix knob	2	0,6
15	70220080000	quick fix handle	2	0,2
16	60300090000	lever pin	2	0,03
17	60240290000	open ring	2	0,02
18	60190040000	big flat washer	2	0,1
19	60200470000	flat washer	2	0,02
20	20040140830	small triangle knob	2	0,5
21	60140080000	Hex nut	2	0,05
22	60090240000	Hexagon head bolts	2	0,05
23	60150020000	hex self-locking nut	2	0,05
24	60090220000	Hexagon head bolts	2	0,05
25	70080250290	aluminum bracket-upper	2	3,6
26	60180130000	conical spring washer	2	0,1
27	70030850000	rotating shaft for quick lever	2	1,1
28	70220140830	aluminium quick lever	2	1,8
29	20240020000	fastener	1	0,15
30	20400140000	rear baffle	1	4,8
31	20400150000	rear baffle window	1	0,5
32	60170290000	recessed Pan head self-tapping screw	18	0,06
33	20380100000	rear discharge cover	1	3
34	70030830000	Shaft for rear discharge cover	1	1,1

35	60380590000	rear discharge cover spring -R L	1	0,5
36	60380580000	rear discharge cover spring -L	1	0,5
37	20390040000	the base of rear discharge cover	1	0,46
38	60170600000	cross recessed Pan head tapping screw	8	0,06
39	20160190000	mulching plug	1	2,3
40	20750210000	rubber dust proof board	1	0,6
41	70030840000	dust proof board for shaft	1	0,3
42	60300030000	R type pin	2	0,02
43	70850810000	rear drive assy	1	10,8
44	20260240000	height adjustment handle	1	0,8
45	20550050830	cover for height adjustment handle	1	0,2
46	60150170000	hex self-locking nut	2	0,05
47	60060530000	hex bolt	2	0,06
48	60200560000	big washer	2	0,1
49	60180120000	wave form washer	4	0,02
50	20610160000	inner cover of hub	2	0,56
51	20880460830	wheel assy	2	6,62
52	60150090000	hex self-locking nut	14	0,06
53	20620290290	outer cover of hub	2	0,56
54	70860500000	selfpropelled assy.	1	32
55	60290070000	Ratchet Wheel pin	2	0,1
56	20430030440	rear wheel axle sleeve	2	0,35
57	21070030000	selfpropelled ratchet washer	4	0,04
58	70300200000	Ratchet Wheel R	1	1,9
59	60240060000	spring washer	6	0,04
60	70300190000	Ratchet Wheel L	1	1,9
61	70050310000	Brake spring	1	1,2
62	60410560000	selfpropelled spring	1	0,08
63	70840310000	front drive assy	1	4,8
64	20610170290	inner cover of hub	2	0,45
65	20880470830	wheel assy	2	3,2
66	20620300290	outer cover of hub	2	0,45
67	60410660000	front drive spring	2	0,2
68	70180400830	Height Adjustment Pull Rod	1	2,30

69	60240300000	blocked plate	2	0,06
70	20200300000	front face mask	1	3,5
71	20200320830	front face screwing	1	1,9
72	20200310830	grass board	1	0,86
73	20200330830	front face plate cover	1	0,3
74	70080230290	aluminum low bracket-left	1	5,2
75	70080240290	aluminum low bracket-right	1	5,2
76	20590020000	cable stopper	1	0,02
77	60370020000	"0" ring	1	0,02
78	20460010000	inlet		0,1
79	20460030000	outlet	1	0,1
80	60040160000	Half round head square neck bolts	4	0,06
81	70742070130	deck	1	42,00
82	70060120130	Bracket plate for defelctor	1	0,30
83	60170580000	ross recessed Pan head tapping scre	2	0,06
84	70030820000	Mulch Shaft	1	0,4
85	60390250000	mulch board spring	1	0,4
86	20120120830	mulching board	1	0,90
87	20110160000	side discharge cover	1	1,40
88	60320270000	V belt	1	1,30
89	70070570130	front drive right bracket	1	0,8
90	70070560130	front drive left bracket	1	0,8
91	60040020000	Half round head square neck bolts	4	0,06
92	70290350000	rear drive bracket	2	0,5
93	20660240000	belt cover	1	1,82
94	60200530000	square washer	2	0,1
95	60080280000	double-head bolt	2	0,08
96	60060390000	hex tapping screws	1	0,06
97	70140780000	blade adapter	1	5,9
98	70130960000	blade	1	6,80
99	70040070000	blade washer	1	0,45
100	60100020000	bolt of blade	1	0,18
101	20080100830	top of grass box	1	6,2
102	20060060000	h-out board of fabric grass bag co	1	0,38
103	20080110000	top grass box screwing	1	0,6
104	20100100000	lower of grass box - right	1	4,5
105	20100090000	lower of grass box - left	1	4,5
106	20060070830	grass sticker board	2	0,56

107	60171930000	plum flowe self-tapping screws	6	0,05
108	A502220	T475 Li -Estar engine	1	
109	60200550000	big washer	2	0,1
110	60200110000	flat washer	2	0,04
111	30090220000	battery	1	28
112	30050090000	charger	1	8
113	30010330000	insert protector	1	0,2
114	20570220000	control panel assy	1	5,56
114-1	30090210000	insert board component	1	1,8
114-2	20650190000	control panel upper cover	1	1,3
114-3	20650150000	control panel fixed bracket I	2	0,1
114-4	20650160000	control panel fixed bracket II	2	0,1
114-5	20440110000	round convex pressing plate	2	0,08
114-6	30030030000	switch	1	0,3
114-7	60171090000	Cross head self-tapping screws	4	0,08
114-8	20770140000	battery cover plate	1	0,5
114-9	20650180000	control panel low cover	1	1,3

T475 锂电启动汽油机定速带刹车自充电爆炸图
(2并自动风门)

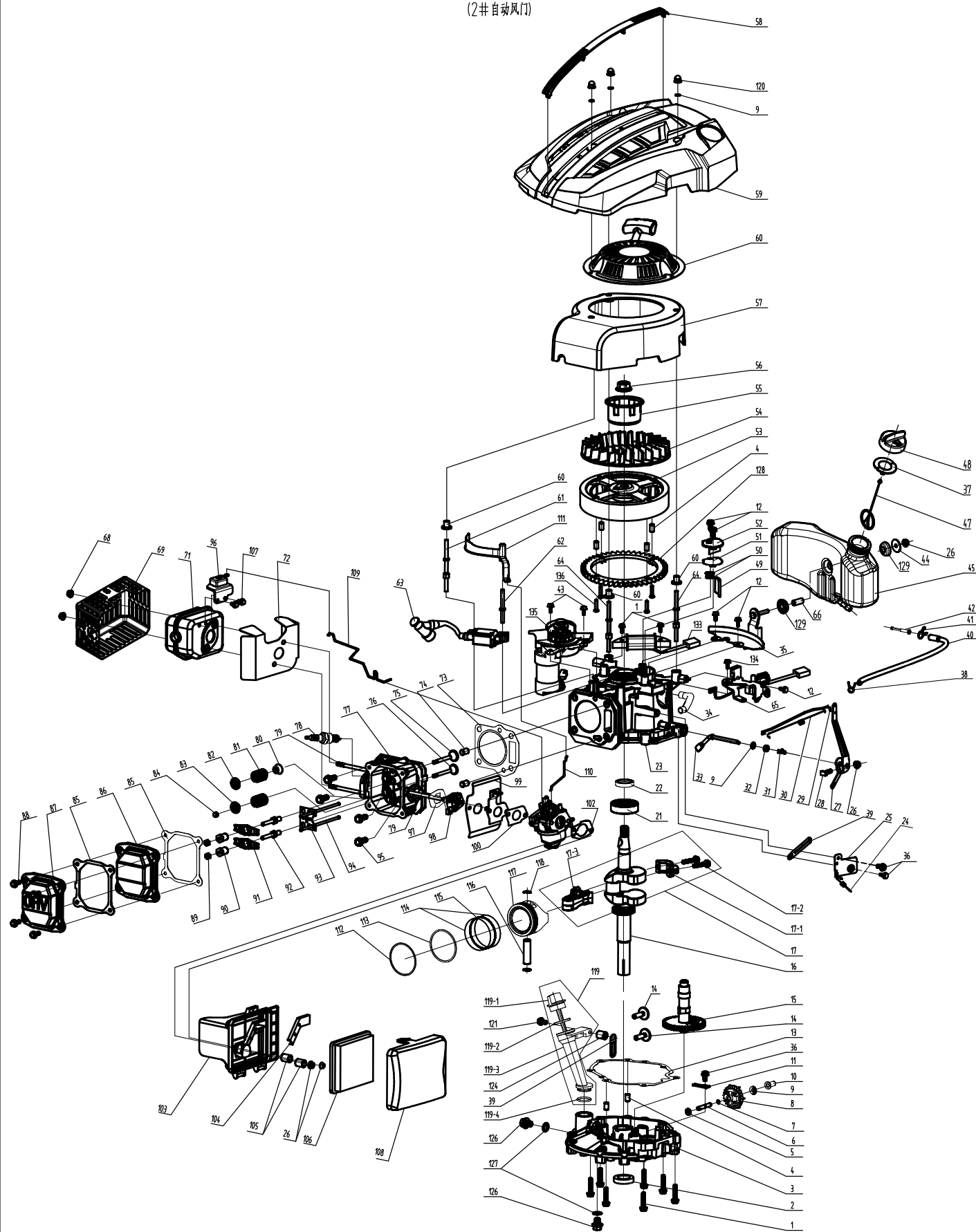

						T475				宁波市德霖机械有限公司	
										锂电启动汽油机(2并自动风门)	
标记	人数	分区	更改文件号	签名	年月日	阶段标记	数量	重量	比例		
设计			标准化			S	1		1.5		
校对			审定								
审核											
工艺			批准								
						共 1 页		第 1 页		版本 A0	

Pos.	Číslo	Poč.	Název
1	60060590000	9	Bolt
2	60360100000	1	oil seal
3	75240140000	1	Crank box cover
4	60280030000	6	spacing pin
5	60200060000	1	Gasket
6	75270010000	1	rate-limiting gear shaft
7		1	Gear Shaft circlip
8	75520020000	1	rete-limiting gear assy.
9	60200490000	2	Gasket
10	25070010000	1	Sliding Sleeve
11	75280010000	1	rate-limiting gear shaft
12	60060520000	5	Bolt
13	75720240000	1	
14	75250010000	2	pin
15	75470020000	1	camshaft assy.
16	75510600000	1	crankshaft assy.
17	75460020000	1	connecting rod assy.
18		1	
19		2	
20		1	
21	60010140000	1	rolling bearing
22	60360090000	1	oil seal
23	75500080000	1	crankshaft box
24	60410470000	1	throttle control spring
25	75360010000	1	throttle assy.
26	60140020000	7	Hex flange nuts
27	75070010000	1	throttle rocker arm
28	60060730000	1	bolt
29	75160010000	1	Handspike of Valve
30	60410050000	1	valve spring
31	60300040000	1	R type pin
32	60360080000	1	oil seal
33	75290010000	1	rate-limiting rocker arm shaft
34	25030050000	1	waste pipe
35	75330050000	1	main bracket of fuel tank
36	60060510000	3	
37	60440330000	1	left bracket of fuel tank
38	60230010000	1	fuel pipe lock clamp II
39	60450010000	2	clip
40	25160010000	1	fuel pipe
41	60230020000	1	fuel pipe lock clamp I
42	25150010000	1	
43	60060580000	2	Bolt
44	60190310000	1	Cushion Blocking gasket
45	25180210000	1	fuel tank body
46			
47	25250080000	1	fuel tank cap sponge
48	25170100000	1	fuel tank cap
49	75150010000	1	oil filter net
50	75100020000	2	
51	75720150000	1	
52	75400010000	1	Respirator Cover Plate Assy
53	75390170000	1	flywheel assy
54	25040110000	1	fan
55	75210010000	1	starter hub
56	60140050000	1	Hex flange nuts
57	25010170000	1	Blower Housing

58	20740100830	1	
59	25190120000	1	
60	75430110000	1	
61	60080200000	1	Different-shaped double-head bolts I
62	60061080000	1	Bolt
63	75370030000	1	ignition assy.
64	60080210000	2	Different-shaped double-head bolts II
65	75380300000	1	detent assy.
66	60240250000	1	
67			
68	60150100000	2	Self-locking nut
69	75530090000	1	muffler cover assy.
70			
71	75540120000	1	muffler assy.
72	75740080000	1	
73	75720100000	1	
74	60280020000	2	spacing pin
75	75170010000	1	IntakeValve
76	75190010000	1	Exhaust Valve
77	75490020000	1	cylinder head assy.
78	75140010000	1	spark plug
79	60080030000	4	Dual-head bolts
80	60360130000	1	oil seal assy
81	60380080000	2	valve spring
82	75180010000	1	Spring Coil of Intake Valve
83	75180020000	1	Spring Coil of Exhaust Valve
84	75200010000	1	Top Cover of Exhaust Valve
85	75720270000	2	
86	75220010000	1	cylinder head cover I
87	75220020000	1	cylinder head cover II
88	60060530000	4	Bolt
89	60160030000	2	And nuts
90	60160050000	2	Valve adjustment nut
91	75230010000	2	Rocker of Valve
92	60060760000	2	valve rocker arm support bolts
93	75260010000	1	push rod director plate
94	75350010000	2	push rod
95	60050030000	4	locking bolt
96	30070420000	1	
97	75730020000	1	
98	25090010000	1	Air Inlet Pipe
99	75730200000	1	
100	75410490000	1	
101	75560050000	1	
102	75730100000	2	
103	25110090000	1	
104	25020040000	1	
105		2	
106	25300020000	1	
107			
108	25120050000	1	Air Filter Upper Cover
109	75760150000	1	
110	75760110000	1	
111	25010180000	1	
112	75130060000	1	Piston Ring I
113	75130030000	1	Piston Ring II
114	75060010000	2	Guide Rail
115	75000010000	1	Bushing Ring

116	60310010000	1	piston pin
117	75120010000	1	Piston
118	60400020000	2	Piston Pin circlip
119	25200100130	1	Lubricating Gauge Assy
120		1	
121	60060630000	1	Bolt
122		1	
123		1	
124	25080010000	1	Distance Sleeve of Lubricating Setting
125		1	
126	60061020000	2	Oil drain bolt
127	60200150000	2	Oil drain bolt gasket
128	25250090000	1	
129	25310030000	2	
130	60170840000	3	
131			
132			
133	30040280000	1	
134	60060570000	1	
135	79990850000	1	
136	60170860000	4	
137	60200490000	3	

编制:

校对:

审核: